

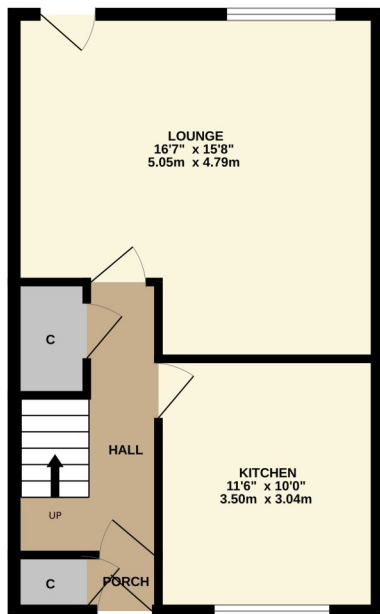

58 Ladyton, Bonhill, G83 9DW

This spacious and well-presented three-bedroom mid-terrace villa is located in the popular Ladyton Estate and is close to a wide range of shops, schooling and public transport links making this an ideal family home.

GROUND FLOOR  
450 sq.ft. (41.8 sq.m.) approx.



1ST FLOOR  
450 sq.ft. (41.8 sq.m.) approx.

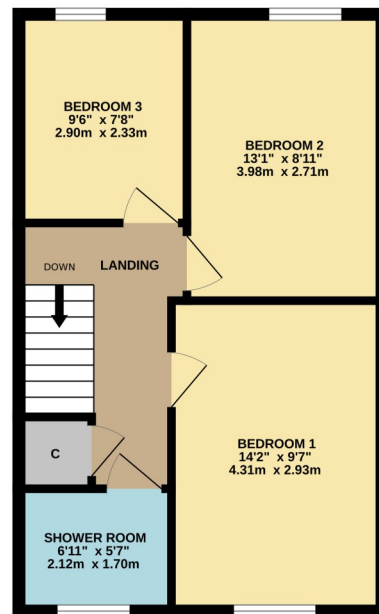

THREE BEDROOM MID-TERRACE VILLA

TOTAL FLOOR AREA : 901 sq.ft. (83.7 sq.m.) approx.

Whilst every attempt has been made to ensure the accuracy of the floorplan contained here, measurements of doors, windows, rooms and any other items are approximate and no responsibility is taken for any error, omission or mis-statement. This plan is for illustrative purposes only and should be used as such by any prospective purchaser. The services, systems and appliances shown have not been tested and no guarantee as to their operability or efficiency can be given.

Made with Metropix ©2024





David Muir Estate Agents  
2 Church Street, Dumbar-  
ton,  
G82 1QL

Tel 01389 734366  
Fax 01389 742476



**Travel Directions**

On leaving Alexandria head towards Bonhill Bridge. From Bridge take right to Bonhill. Proceed up hill and take second left and then second right. No 58 is on your right.

**Additional Information**

Home Report Valuation: £105,000

Council Tax Band: B

Energy Efficiency Rating: C

Double Glazing

Gas Central Heating

**Home Report**

This property benefits from a Home Report which can be obtained from [davidmuirestates.com](http://davidmuirestates.com) or [onesurvey.org](http://onesurvey.org)